

Revision	Description	Drawn	Checked	Date
P1	First issue	NJC	DWW	26.03.19

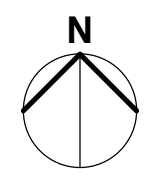

River Derwent

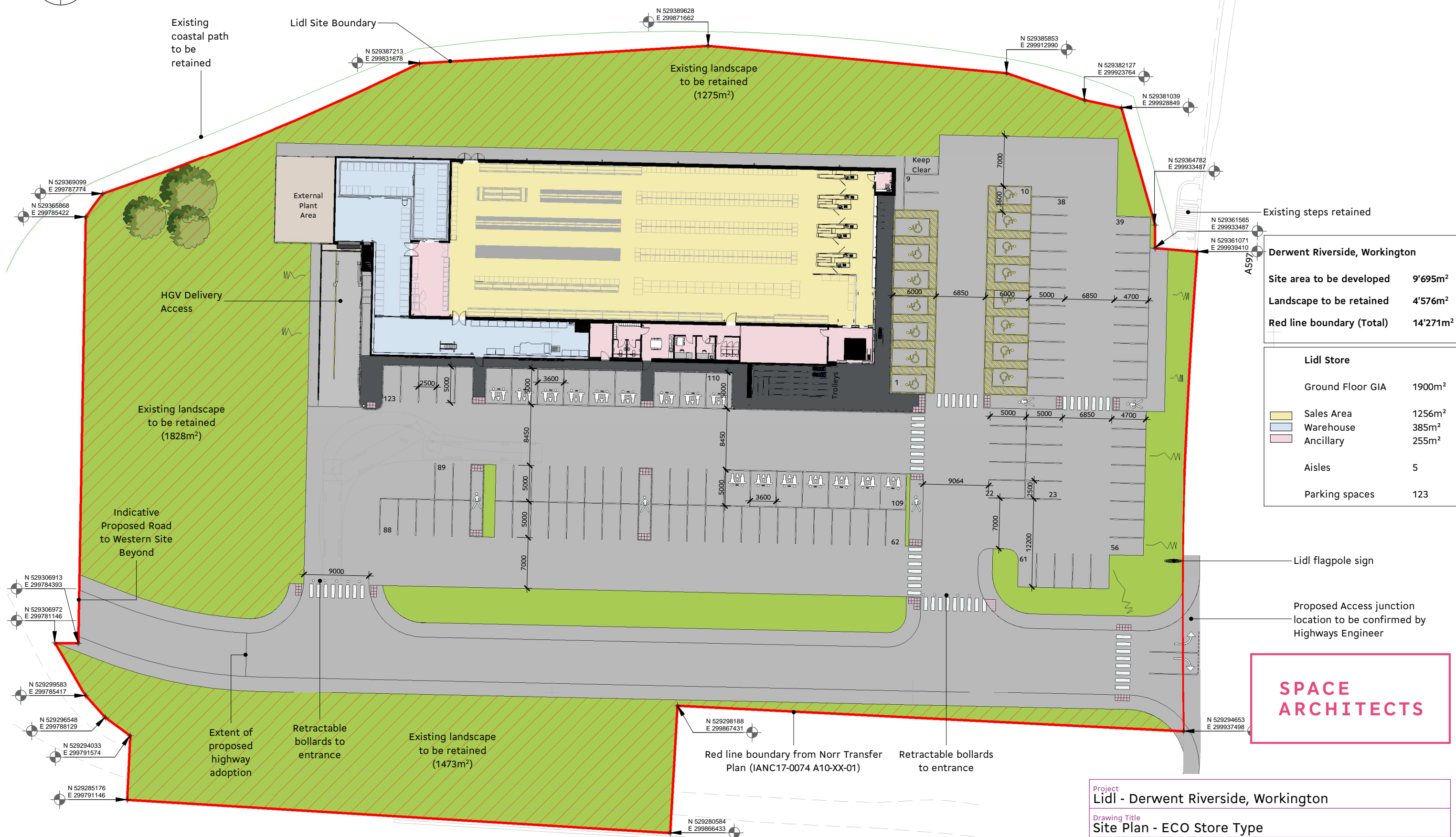

**Derwent Riverside, Workington**

Site area to be developed	9'695m <sup>2</sup>
Landscape to be retained	4'576m <sup>2</sup>
Red line boundary (Total)	14'271m <sup>2</sup>

**Lidl Store**

Ground Floor GIA	1900m <sup>2</sup>
Sales Area	1256m <sup>2</sup>
Warehouse	385m <sup>2</sup>
Ancillary	255m <sup>2</sup>
Aisles	5
Parking spaces	123

**SPACE ARCHITECTS**

Project <b>Lidl - Derwent Riverside, Workington</b>					
Drawing Title <b>Site Plan - ECO Store Type</b>					
Project No. <b>07714</b>	Originator <b>SPACE</b>	Volume <b>00</b>	Level - Type - Role - Class - No. <b>XX-DR-A-91-1001</b>	Suitability <b>S3</b>	Revision <b>P1</b>
File Reference <b>07714-SPACE-00-XX-DR-A-91-1001-S3-P1</b>				Scale at A3 <b>1 : 500</b>	

This drawing is Copyright - Check all dimensions on site - Inform architect of any discrepancies - Work to figured dimensions only  
Do not scale